

R3	07-07-20	REVISED AS PER COMMENTS FROM DESIGN CIRCLE (R&B)
R2	27-09-19	REVISED AS PER SITE CONDITION
R1	31-10-17	REVISED THE BRIDGE ALIGNMENT NEAR MANAV UTTAM AS PER INSTRUCTION OF BRIDGE CELL, SMC.
REV	DATE	DESCRIPTION
PROJECT: CONSTRUCTION OF FLYOVER BRIDGE AT VED DARWAJA ON KATARGAM ROAD, SURAT		
CLIENT: MUNICIPAL COMMISSIONER SURAT		
CONTRACTOR: RANJIT BUILDCON LTD. AHMEDABAD		
CIVIL ARCHITECTURAL STRUCTURAL ANALYSIS DESIGN 101, DEV ASHISH, 14/B, JAIN SOCIETY, NR. PRITAM NAGAR AKHADA, OPP. KOCHHRAB ASHRAM, ELLISBRIDGE, AHMEDABAD-380 006. PH:- 079-26582151 EMAIL:- casadconsultants@gmail.com		
TITLE: GENERAL ARRANGEMENT DRAWING		SHEET: 1/2
DRAWN BY: J.S.PATEL	CHECK BY: K.I.GAJJAR	
DESIGN BY: M.M.MODY	APPROVED BY: J.B.GANDHI	
PROJECT NO. 2017-07	DRG. NO. SMC / VDD / GAD / 01	
DATE: 07.07.2020	SCALE: AS SHOWN	R3

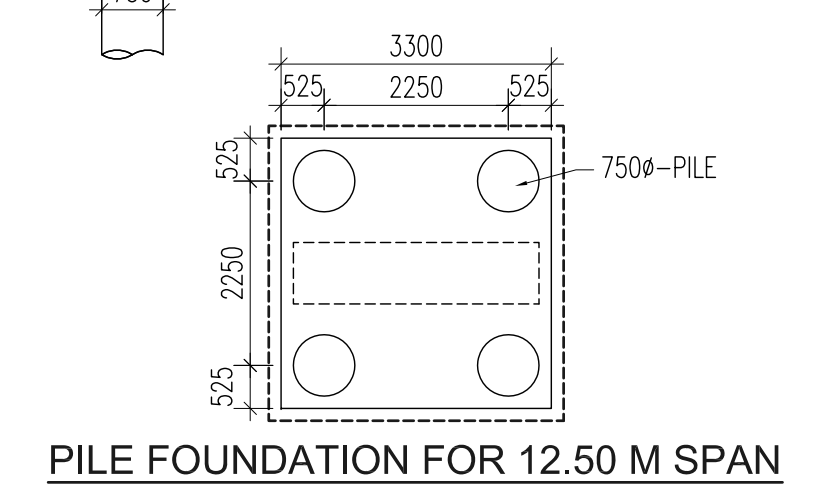

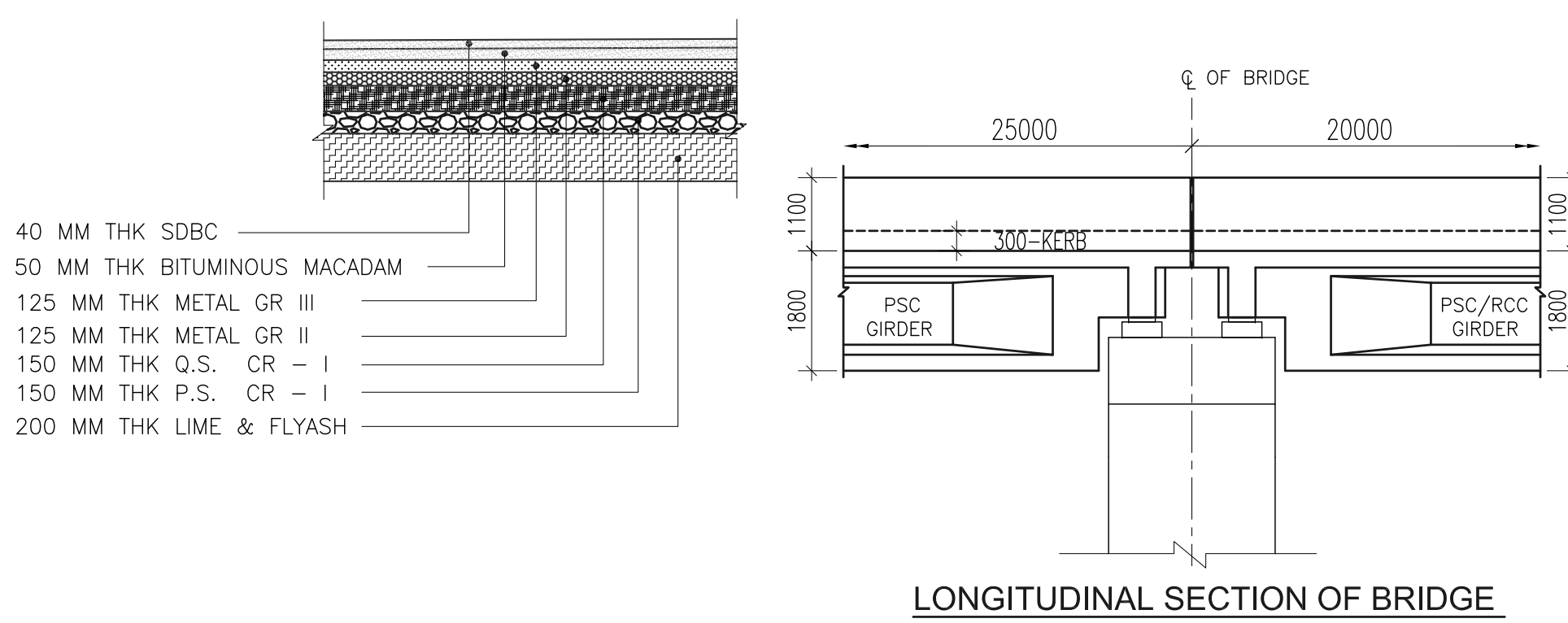
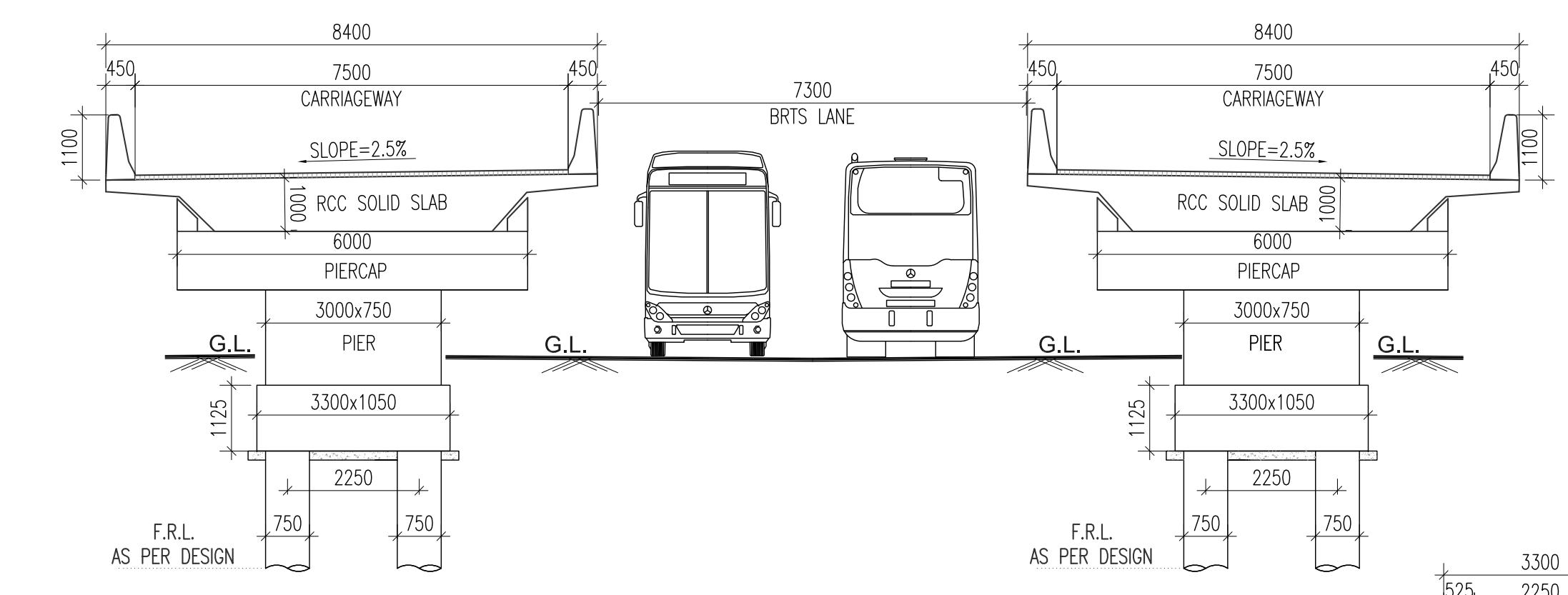
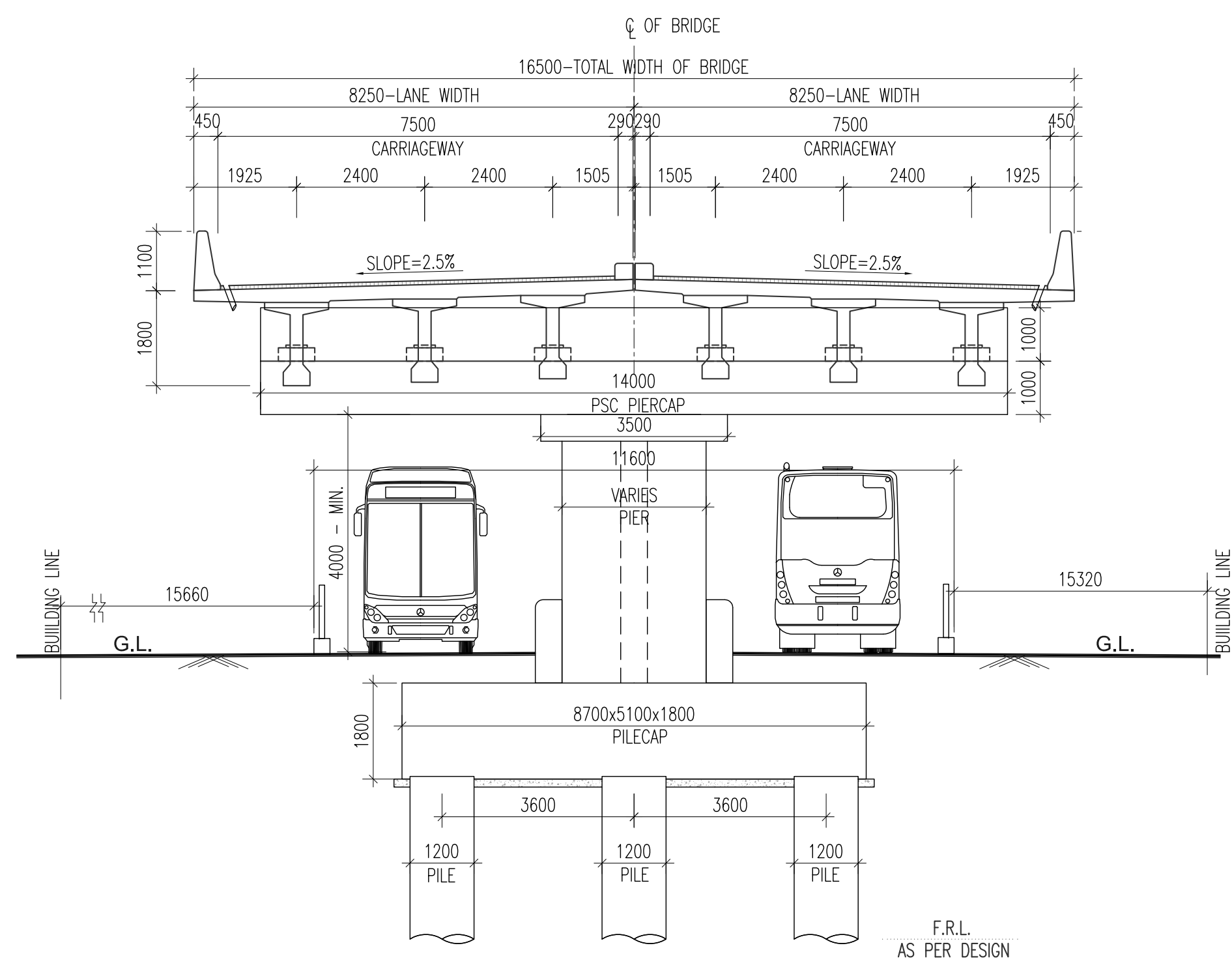
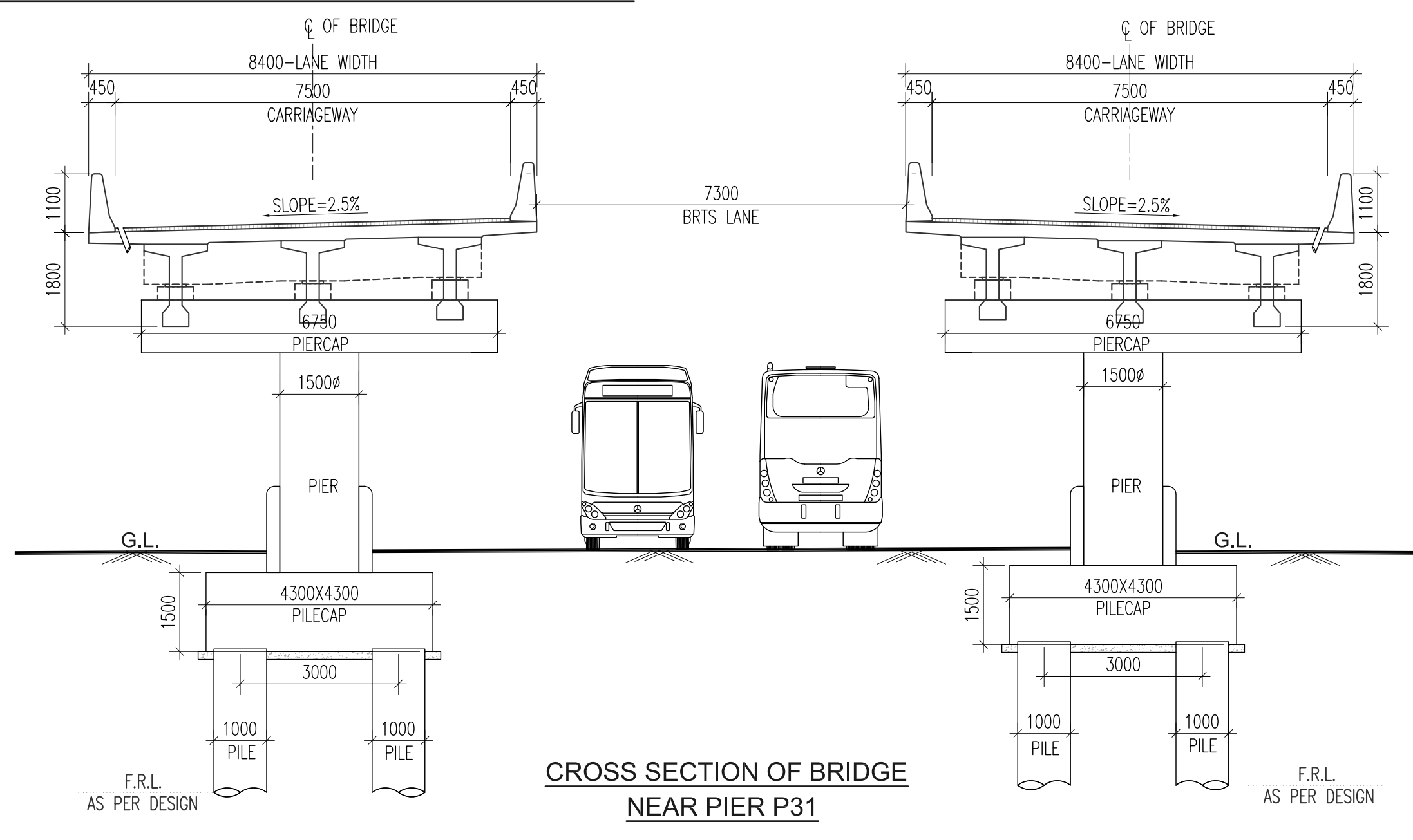
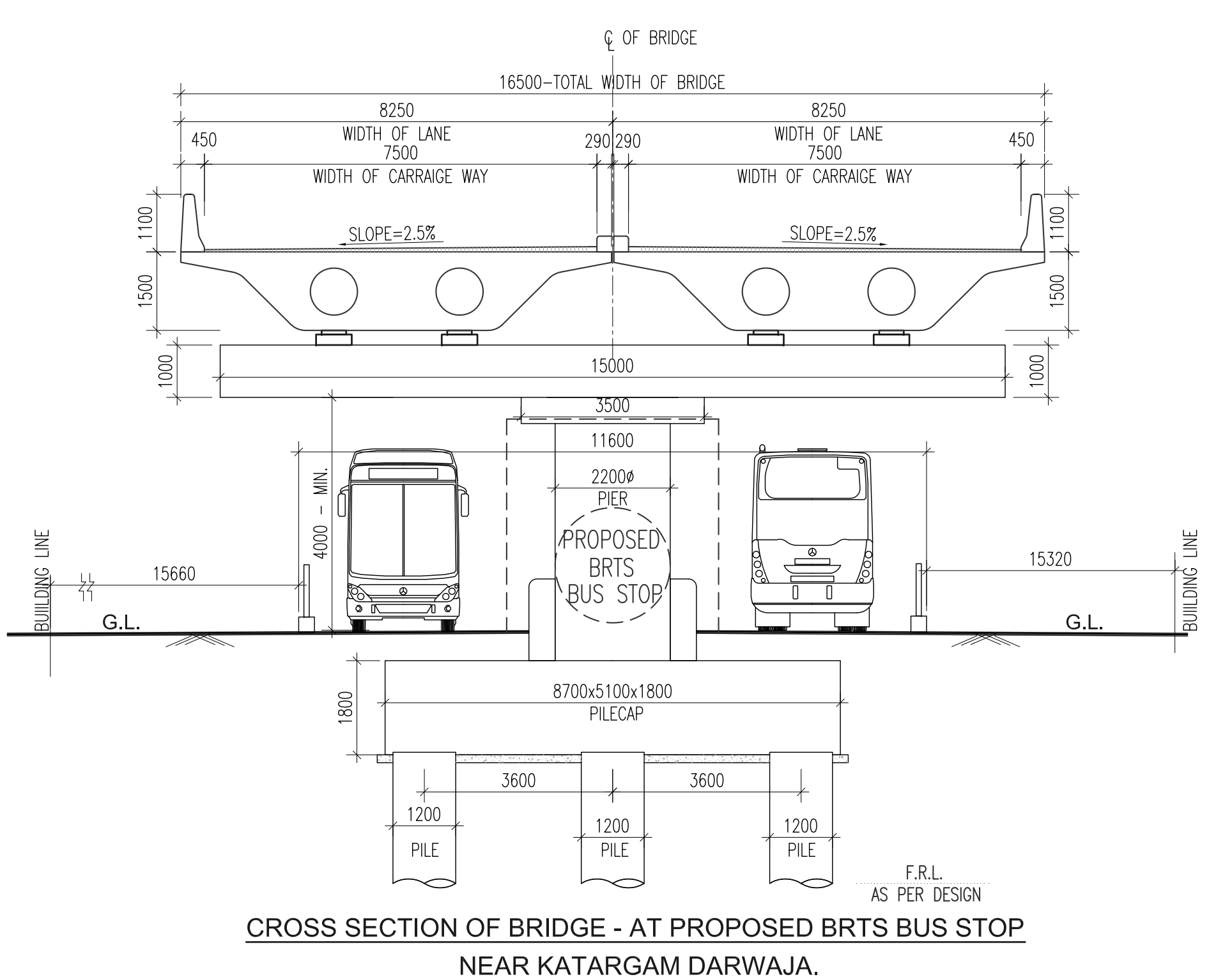
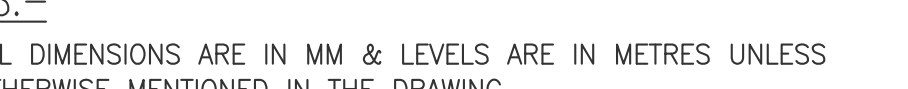
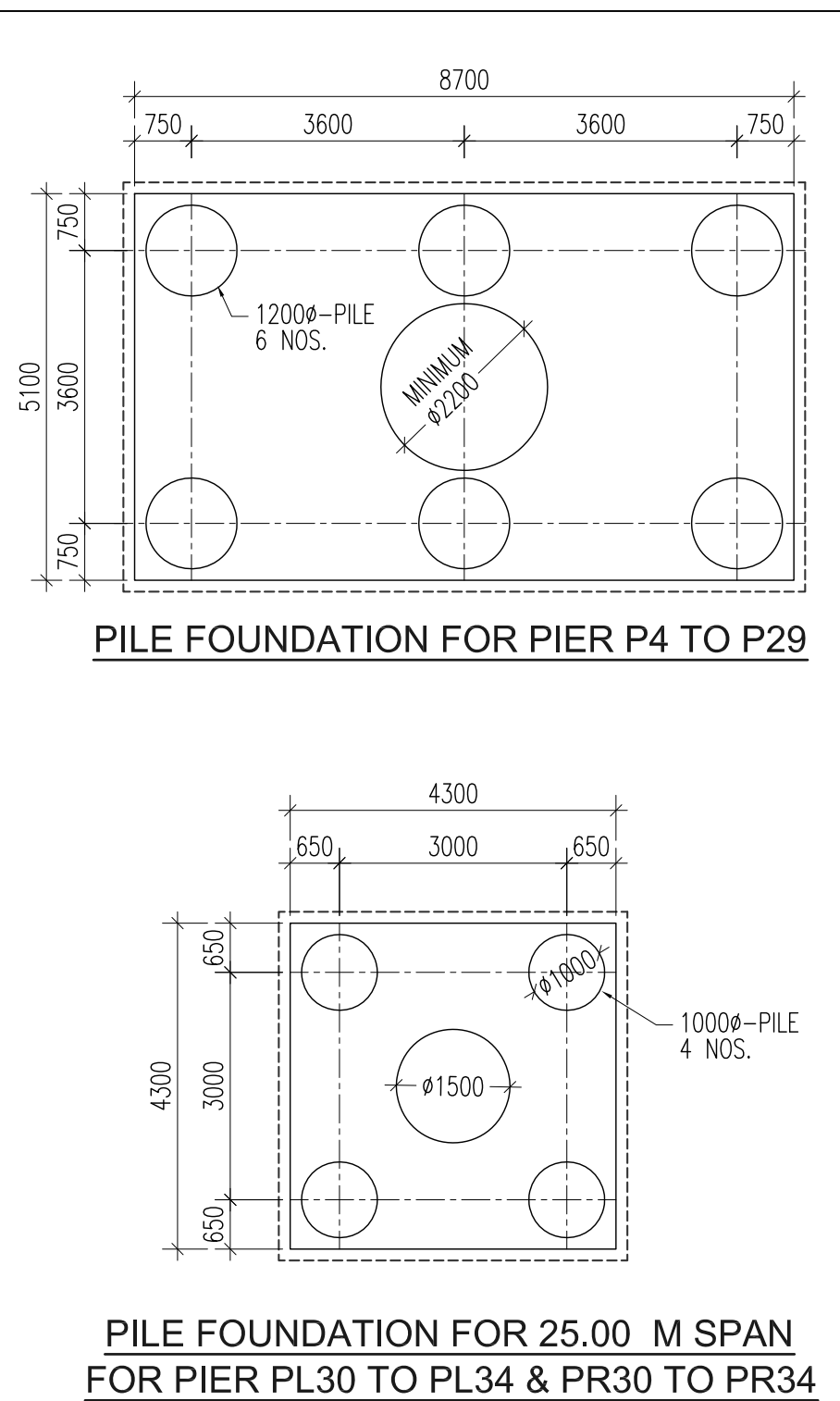
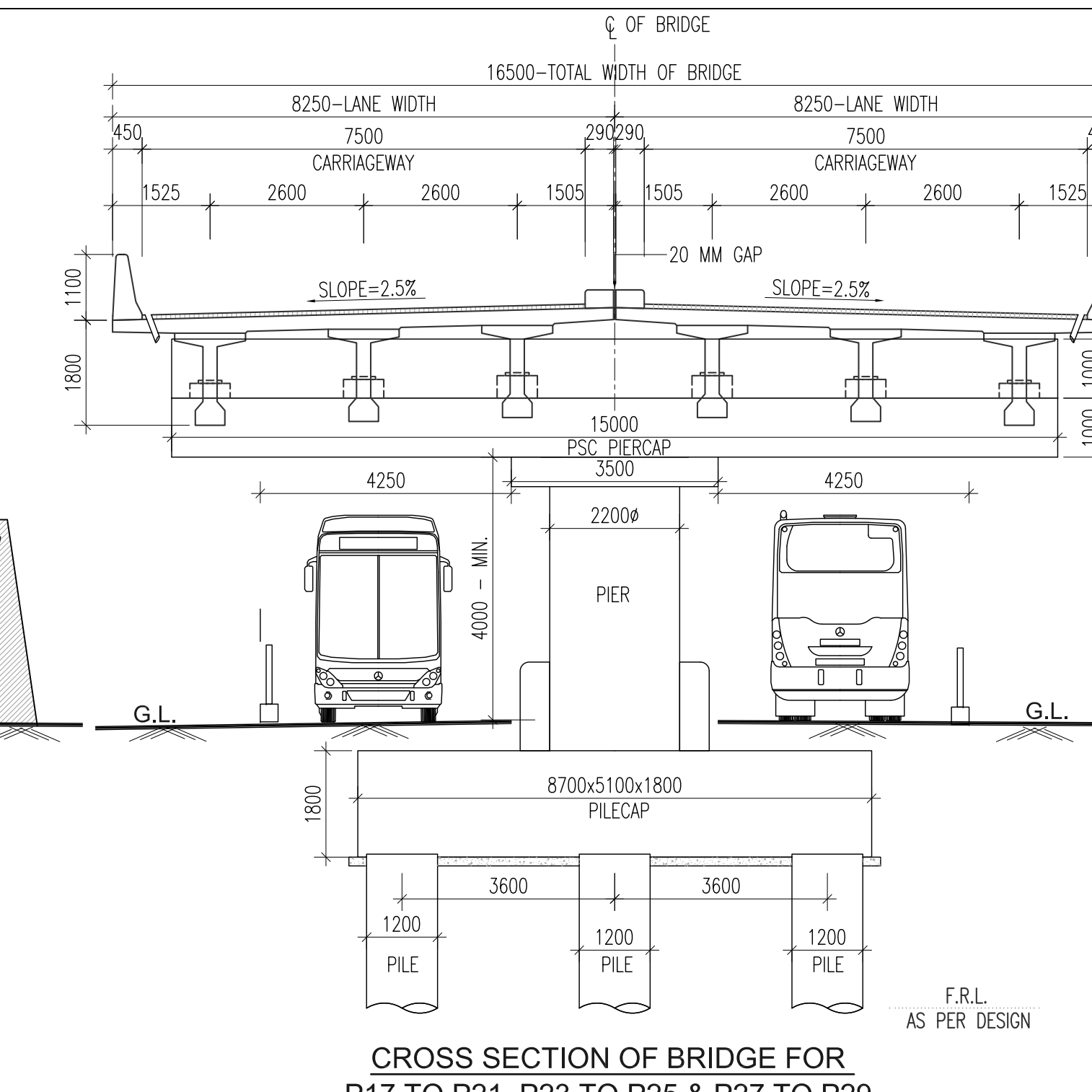
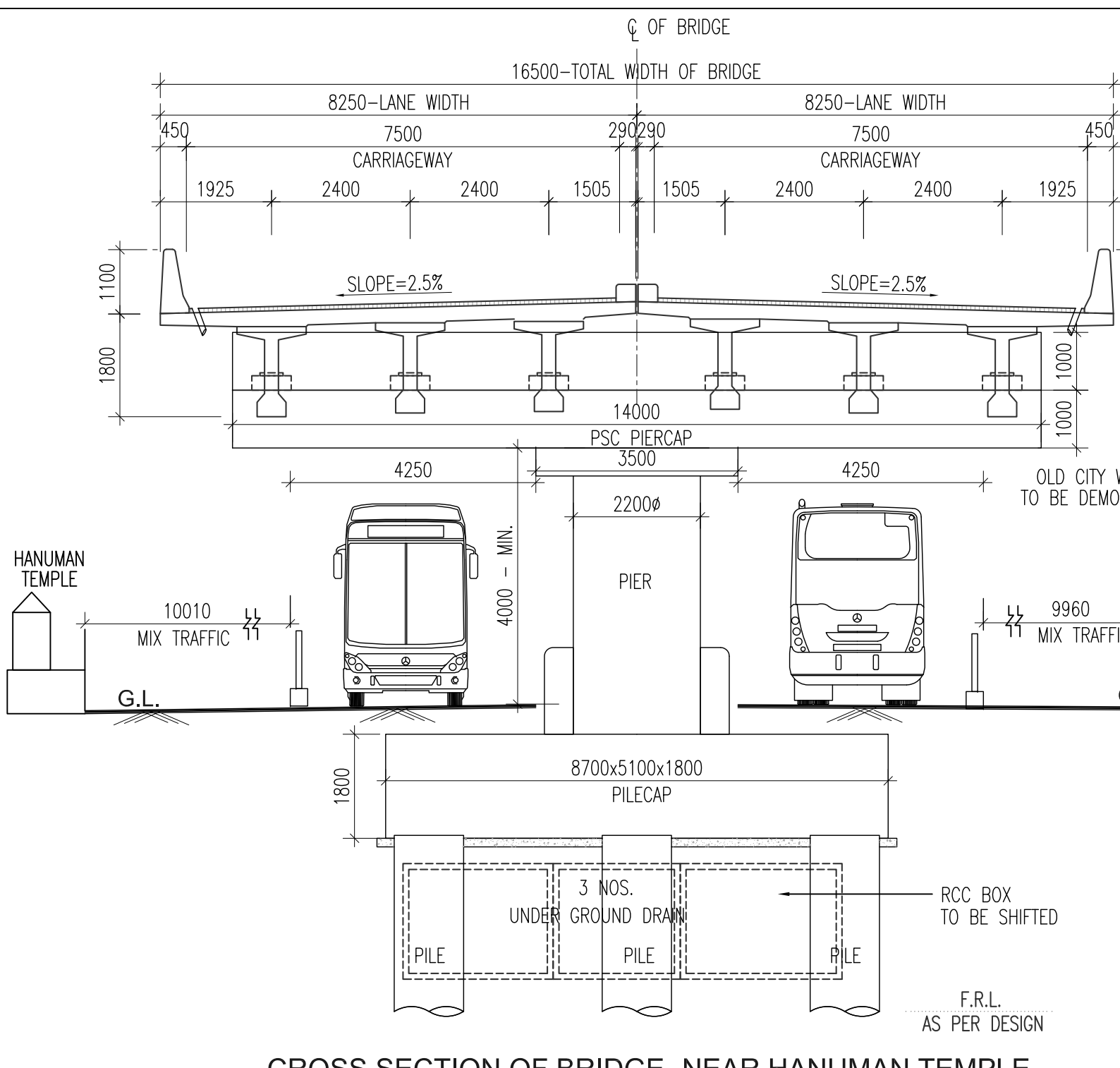
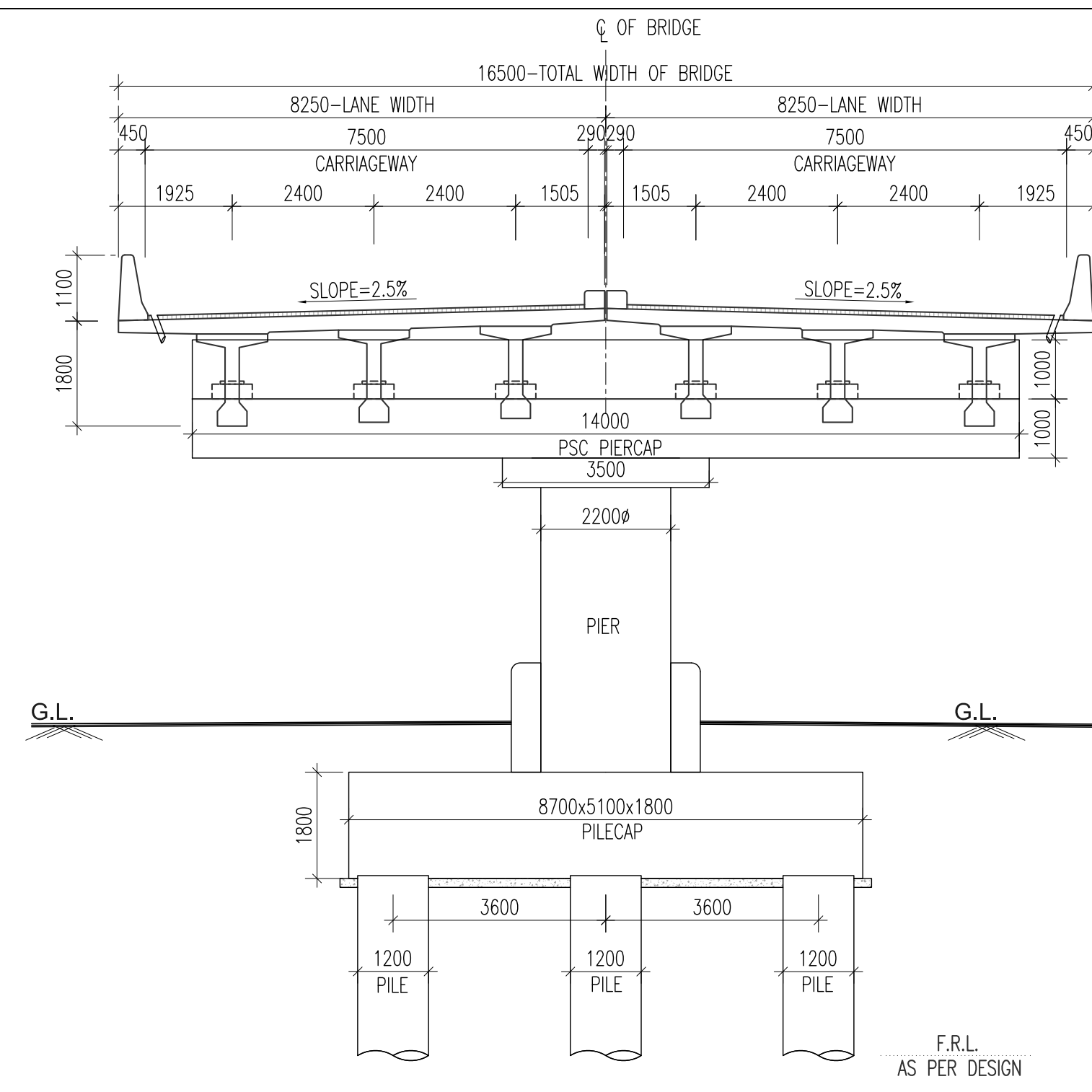
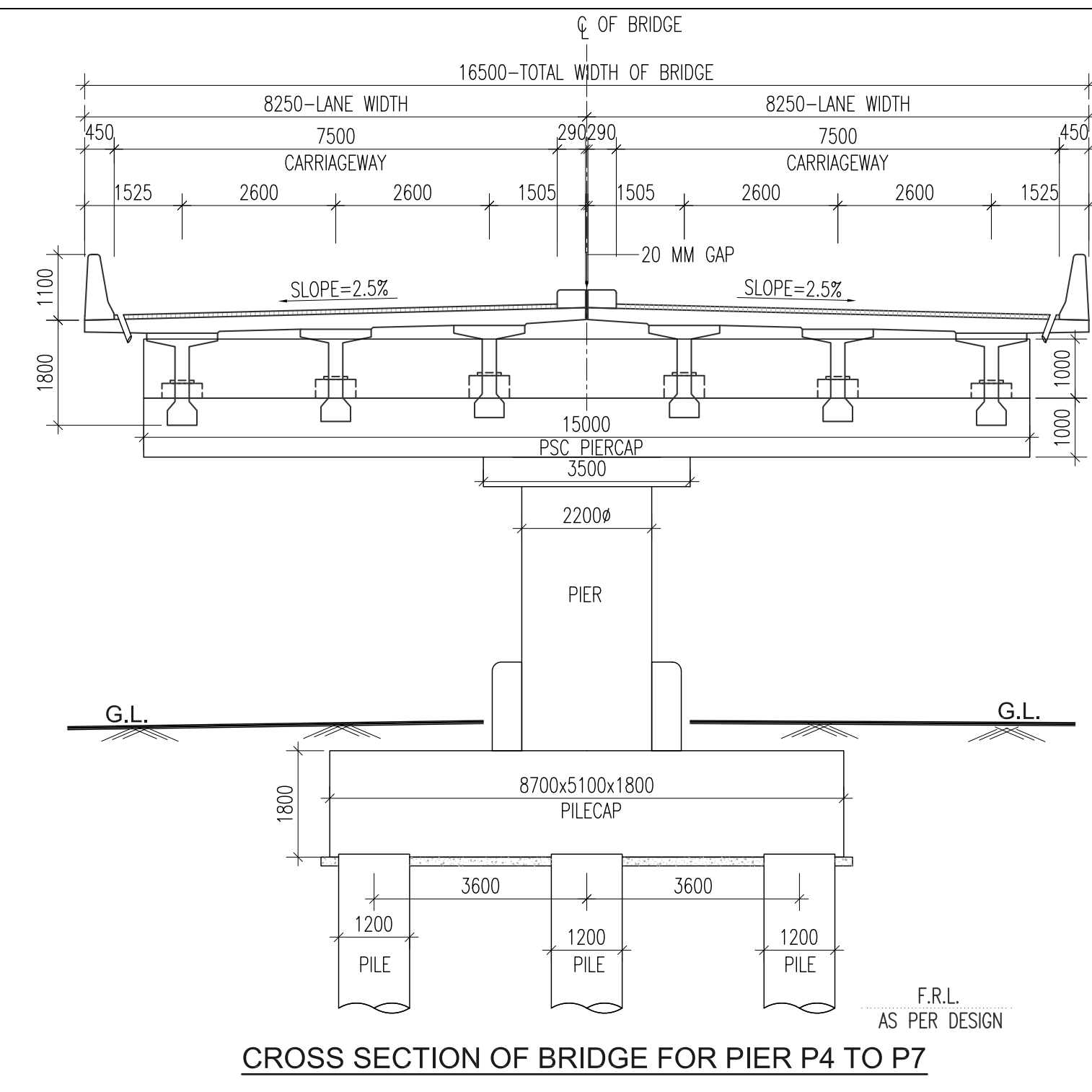

- NOTES:-
- ALL DIMENSIONS ARE IN MM & LEVELS ARE IN METRES UNLESS OTHERWISE MENTIONED IN THE DRAWING.
  - NO DIMENSION SHALL BE SCALED FROM THIS DRAWING. ONLY WRITTEN DIMENSIONS SHALL BE FOLLOWED.
  - STRUCTURAL DETAILS, DIMENSIONS & CONC. GRADES SHOWN IN THIS DRAWING ARE TENTATIVE AND ANY UNIT AND ITS DIMENSION WILL BE AS PER DETAILED DESIGN AND WORKING DRAWINGS.
  - DESIGN SHALL BE AS PER LATEST RELEVANT CODE(S) OF IRC AND OTHER CODES AS APPROVED BY MOSR&H.
  - STRIP SEAL TYPE EXPANSION JOINTS OF APPROVED MOSR&H MANUFACTURER SHALL BE PROVIDED IN DECK AT EXPANSION GAPS.
  - THE BRIDGE WILL BE DESIGNED FOR BELOW MENTIONED IRC LOADING
    - EACH TWO LANE BRIDGE SHALL BE DESIGNED FOR IRC CLASS "A" TWO LANE LOADS OR ONE LANE OF 70R WHEELED OR TRACKED VEHICLES, WHICH EVER IS SEVERE AND GOVERNING.
  - STEEL USED SHALL BE TMT BARS Fe-500 CONF. TO I.S. 1786.
  - CRASH BARRIER SHALL BE PROVIDED AS PER MOSR&H STANDARD DRAWINGS.
  - BEARINGS = ELASTOMERIC / POT-PTFE
  - DRAINAGE SPOUT & WEARING COAT SHALL BE AS PER MOSR&H STANDARD DRAWINGS SD-303.
  - DEPTH OF FOUNDATION SHALL BE PROVIDED AS PER DETAILED GEOTECHNICAL SURVEY, DESIGN REQUIREMENT AND IRC.
  - BRIDGE SHALL BE DESIGNED CONSIDERING LOCATION AS SEISMIC ZONE III.
  - CLEAR COVER TO MIAN REINFORCEMENT -
    - 75 MM FOR PILE/PILECAP/PIER.
    - 50 MM FOR OTHER COMPONENTS.
    - 40 MM FOR SUPER STRUCTURE.

REV	DATE	DESCRIPTION
R3	07-07-20	REVISED AS PER COMMENTS FROM DESIGN CIRCLE (R&B)
R2	27-09-19	REVISED AS PER SITE CONDITION
R1	04-11-17	REVISED THE BRIDGE ALIGNMENT NEAR MANAV UTTHAN AS PER INSTRUCTION OF BRIDGE CELL, SMC.

PROJECT:  
**CONSTRUCTION OF FLYOVER BRIDGE AT VED DARWAJA ON KATARGAM ROAD, SURAT**

CLIENT:  
**MUNICIPAL COMMISSIONER SURAT**

CONTRACTOR:  
**RANJIT BUILDCON LTD. AHMEDABAD**

**CASAI** CONSULTANTS PVT. LTD.  
 CIVIL ARCHITECTURAL STRUCTURAL ANALYSIS DESIGN  
 101, DEV ASHISH, 14/B, JAIN SOCIETY, NR. PRITAM NAGAR AKHADA, OPP. KOCHRAB ASHRAM, ELLISBRIDGE, AHMEDABAD-380 006. PH:- 079-26582151 EMAIL:- casadconsultants@gmail.com

TITLE: **GENERAL ARRANGEMENT DRAWING** SHEET **2/2**

DRAWN BY: **J.S.PATEL** CHECK BY: **K.I.GAJJAR**  
 DESIGN BY: **M.M.MODY** APPROVED BY: **J.B.GANDHI**

PROJECT NO. **2017-07** DRG. NO. **SMC / VDD / GAD / 01**  
 DATE: **07.07.2020** SCALE: **AS SHOWN** R3