

BASEMENT PARKING PLAN
SCALE : 1 CM. = 4 MT.

VISITORS CAR PARKING			
SR.NO	AREA		SQ.MT.
VCP1	0.5*(23.60+24.65)	X 11.37	= 274.30
TOTAL			= 274.30

VISITORS SCOOTER PARKING			
SR.NO	AREA		SQ.MT.
VSP1	51.89	X 1.5	X 1 = 77.84
VSP2	0.5*(16.37+18.89)	X 10.83	= 190.93
VSP3	9.62	X 1.5	X 1 = 14.43
TOTAL			= 283.20

CAR PARKING			
SR.NO	AREA		SQ.MT.
CP1	0.5*(31.1+37.19)	X 25.82	= 881.62
CP2	24.31	X 21.4	X 1 = 520.23
CP3	5.41	X 14.79	X 1 = 80.01
CP4	12.88	X 19.95	X 1 = 256.96
TOTAL			= 1738.83

SCOOTER PARKING			
SR.NO	AREA		SQ.MT.
SP1	33.72	X 8.97	X 1 = 302.47
SP2	29.42	X 16.85	X 1 = 495.73
SP3	26.52	X 17.45	X 1 = 462.77
SP4	7.20	X 19.95	X 1 = 143.64
SP5	9.71	X 5.40	X 1 = 52.43
TOTAL			= 1457.04

COMMERCIAL PARKING AREA SUMMARY			
SR. NO	REQUIRED PARKING	PROPOSED PARKING	REMARKS
(i)	COMMERCIAL AREA = 9034.20 sq.mt.	Visitors Parking = 557.50 sq.mt. Car Parking = 1738.83 sq.mt.	
(ii)	Parking required as per Reg no.18.1(T) @ 30% (9034.20 X 0.30 = 2710.26 sq.mt.)	Scooter Parking = 1457.04 sq.mt. Total Parking = 3753.37 sq.mt.	
(iii)	Visitors Parking @ 20% on ground lvl. (VP) (2710.26 X 0.20 = 542.05 sq.mt.) Req. Remaining parking = 2710.26 - 542.05 = 2168.21 sq.mt.	Visitors Car Parking = 274.30 sq.mt. Visitors Scooter Parking = 283.20 sq.mt. Total Visitors Parking = 557.50 sq.mt.	AS SHOWN
(iv)	Car Parking @ 50% (CP) (2168.21 X 0.50 = 1084.10 sq.mt.)	Car Parking = 1738.83 sq.mt.	AS SHOWN
(v)	Other Parking @ 50% (P) (2168.21 X 0.50 = 1084.10 sq.mt.)	Scooter Parking = 1457.04 sq.mt.	AS SHOWN

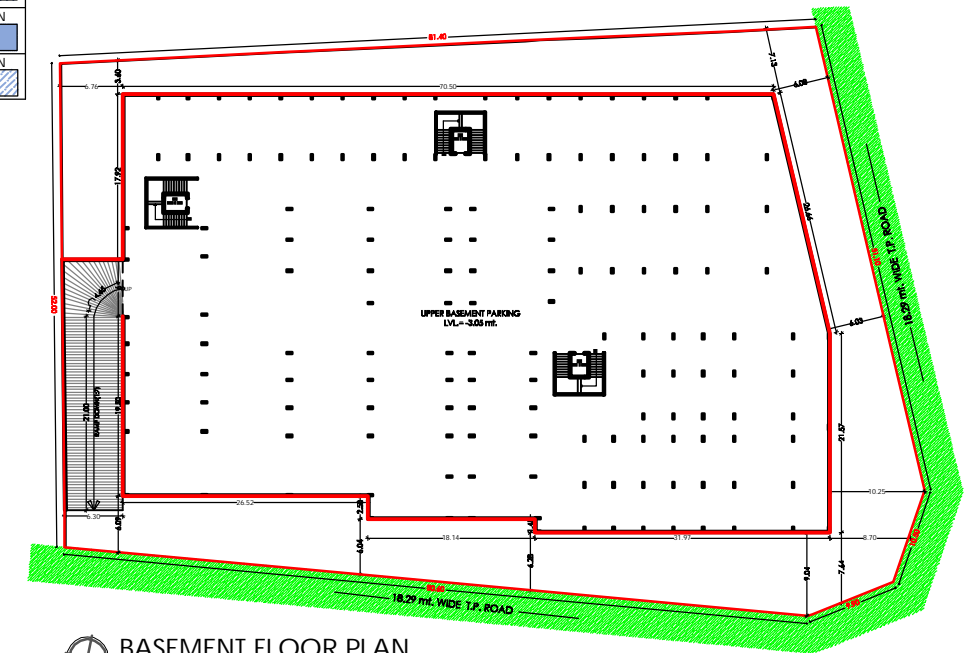

BASEMENT FLOOR PLAN
SCALE : 1 CM. = 4 MT.

BASEMENT AREA CALCULATION			
SR. NO	AREA		SQ.MT.
1	26.52	X 43.57	X 1 = 1155.48
2	43.98	X 25.95	X 1 = 1141.28
3	6.12	X 25.95	X 0.5 = 79.41
4	31.97	X 21.57	X 1 = 689.59
5	18.14	X 20.13	X 1 = 365.16
TOTAL			= 3430.92

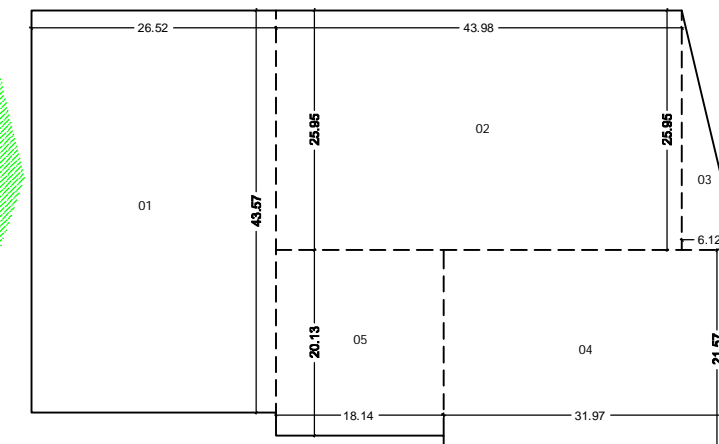

BASEMENT AREA CALCULATION SKETCH
SCALE : 1 CM. = 4 MT.

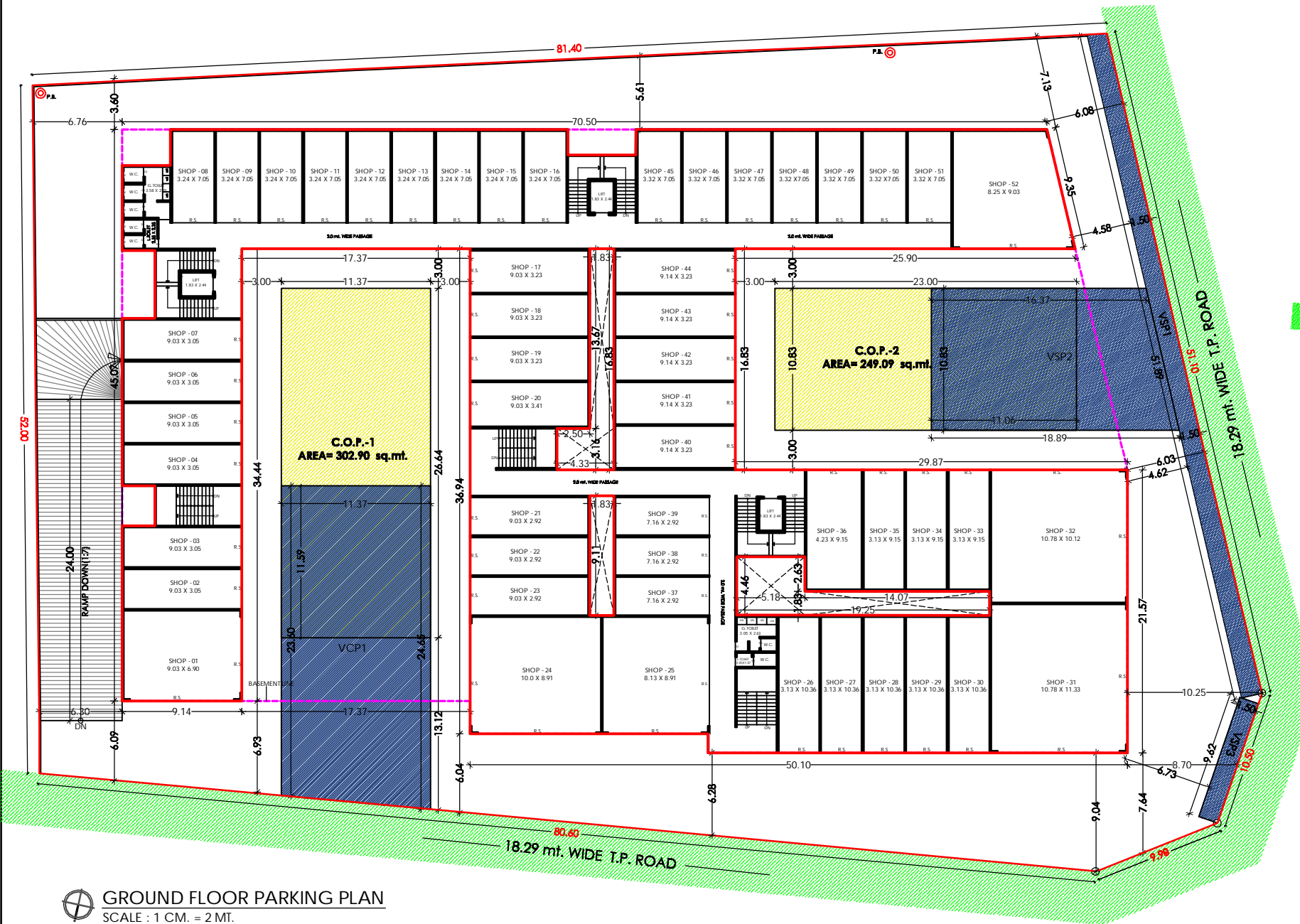

GROUND FLOOR PARKING PLAN
SCALE : 1 CM. = 2 MT.

OWNER'S SIGN

(1) ANILBHAI JAYANTIBHAI PATI

(2) ROHITBHAI JAYANTIBHAI PA

ARCHITECT

MITESH M. FALAKIY
Reg. No. CA/2005/35442 (B.Arc)
SMC. LIC. NO. TDO/AR/214
A/5001, Ascon plaza,
Anand mahal road,